

ROOILIJNPLAN









Gemeente KORTENBERG 2e Afd/Erps-Kwerps

Sectie F, delen van 17b, 21b2 en 530g

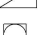
Gemeten en opgemaakt te Beringen,
de 20e oktober 2021

bestuurder Guido Scheers
vr de bv SCHEERS St&G
LAN 04-0841
bvba.scheers@telenet.be

LEGENDE Schaal:1/500

-  verlichtingspaal
-  telefoonkastje
-  deksel riolering
-  elek.cab.
-  deksel water
-  betonnen grenspaal
-  meetnagel
-  af te schaffen rooilijn H tem K
-  nieuwe rooilijn A tem G

LAMBERT72-COORDINATEN

A	164122.85	176952.61
B	164144.69	176950.51
C	164183.47	176946.70
D	164197.43	176945.52
E	164208.15	176944.75
F	164218.88	176944.01
G	164226.43	176943.43
H	164225.99	176942.97
I	164199.53	176944.85
J	164140.30	176950.50
K	164123.33	176952.13

Lot A: 44m² wordt afgestaan aan euro 0

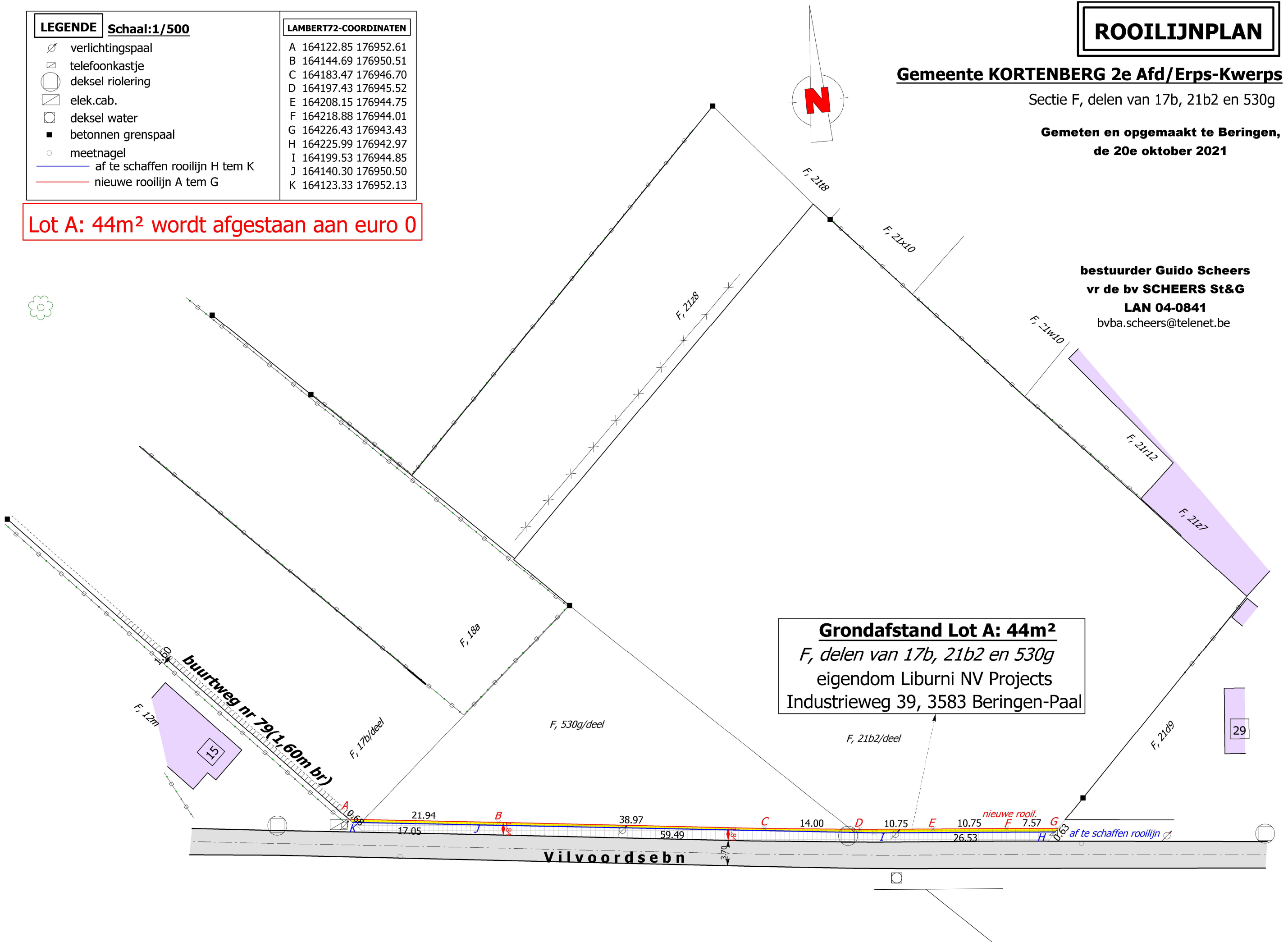

Grondafstand Lot A: 44m²
F, delen van 17b, 21b2 en 530g
eigendom Liburni NV Projects
Industrieweg 39, 3583 Beringen-Paal

buurtweg nr 79 (1,60m br)

Vilvoordsebn

29

21.94 17.05 38.97 59.49 14.00 10.75 10.75 7.57 26.53

nieuwe rooil. A B C D E F G H af te schaffen rooilijn